

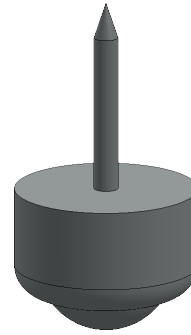



# Sumo Car Ball Glide



## A. Sketch.

- Step 1. Click File Menu > New, click Part and OK.
- Step 2. Click **Front Plane**  in the Feature Manager and click **Sketch**  from the Content toolbar, **Fig. 1**.
- Step 3. Click **Line**  (L) on the Sketch toolbar.

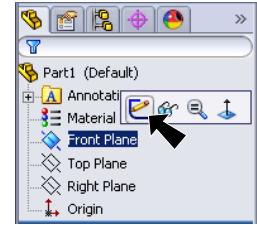

**Fig. 1**

- Step 4. Draw lines starting at the Origin , **Fig. 2**. Use the inferencing line, the dotted line that appears when you draw the lines.

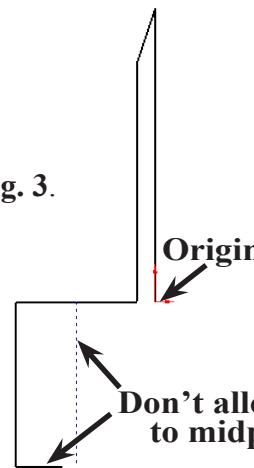
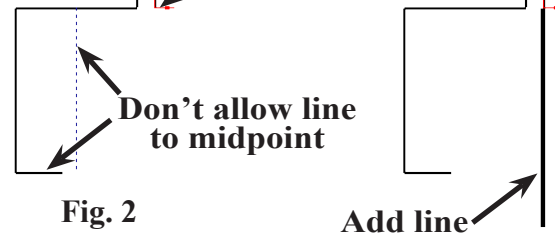

**Fig. 2**

- Step 5. Draw one line down from the Origin , **Fig. 3**.

- Step 6. Click **Smart Dimension**  (S) on the Sketch toolbar.

- Step 7. Add the dimensions as shown in **Fig. 4**. Dimension the **.33** last. Arrange the dimensions as **Fig. 4**.



**Fig. 3**

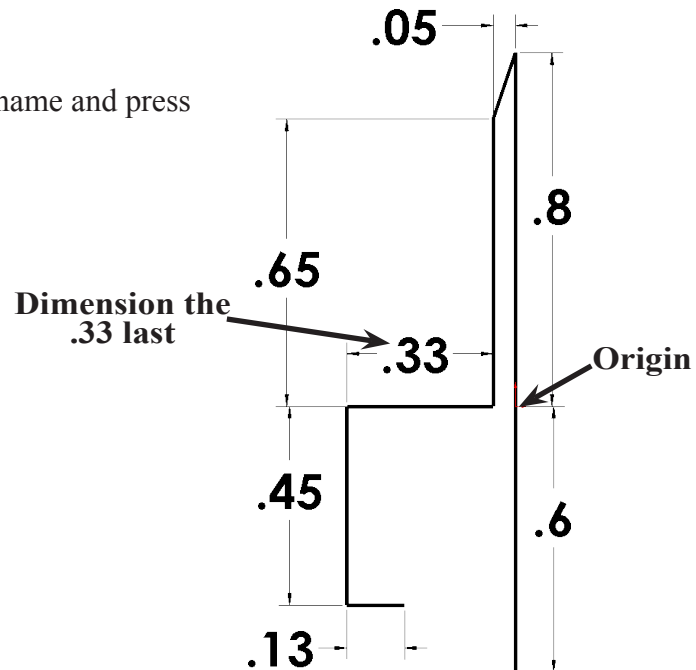

## B. Save as "BALL GLIDE".

- Step 1. Click File Menu > Save As.
- Step 2. Key-in **BALL GLIDE** for the filename and press ENTER.



**Fig. 4**

### C. Tangent Arc.

Step 1. Click **Tangent Arc**  in the **Arc flyout**  on the Sketch toolbar.

Step 2. Draw an arc between the Position 1 and Position 2 in **Fig. 5**.

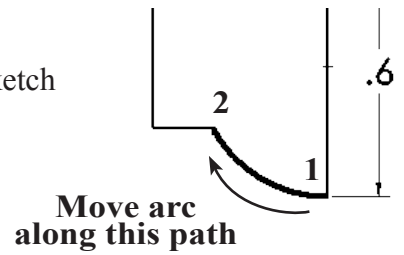





Fig. 5

Step 3. Save. Use **Ctrl-S**.

### D. Sketch Fillet.

Step 1. Click **Sketch Fillet**  on the Sketch toolbar.

Step 2. In the Property Manager set:

**Radius**  **.12**, **Fig. 6**  
 click the corner, **Fig. 7**  
 click OK **twice** .

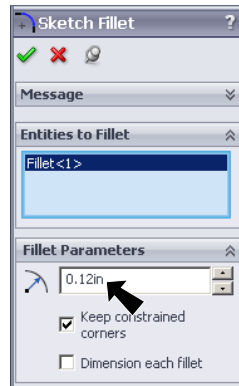

Fig. 6

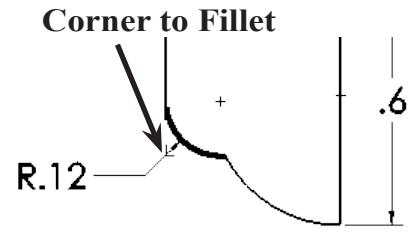



Fig. 7

### E. Revolved Boss/Base.

Step 1. Click **Features**  on the Command Manager toolbar.

Step 2. Click **Revolved Boss/Base**  on the Features toolbar.

Step 3. In the Revolve Property Manger:  
 for **Axes of Revolution**   
 click **vertical right line of sketch**, **Fig. 9**  
 click OK .

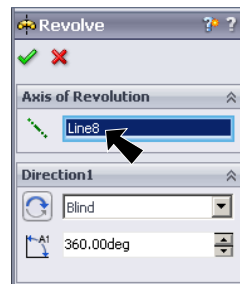

Fig. 8

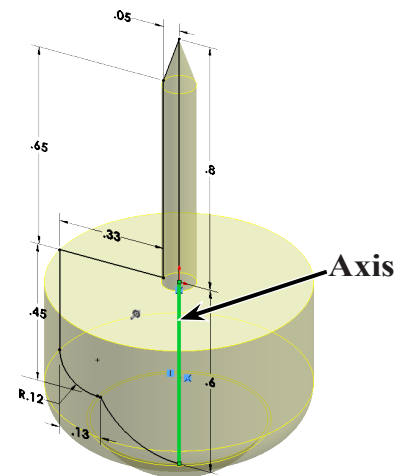

Fig. 9

### F. Material Chrome Stainless.

Step 1. **Right click** **Material**  in the Feature Manager and click **Edit Material**.

Step 2. Expand **Steel** in the material tree and click **Chrome Stainless**. Click **Apply** and **Close**.

Step 3. Save. Use **Ctrl-S**.

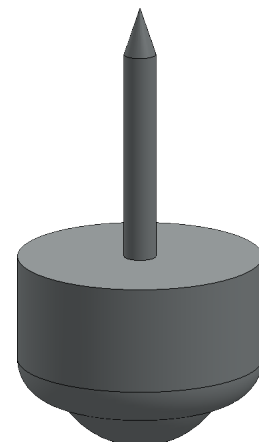

Fig. 10