







## A. Washer.

- Step 1. Click File Menu > New, click **Part** and OK.
- Step 2. Click **Right Plane**  in the Feature Manager and click **Sketch**  from the Context toolbar, **Fig. 1**.
- Step 3. Click **Circle**  (S) on the Sketch toolbar.
- Step 4. Draw two circles starting at the Origin , **Fig. 2**.
- Step 5. Click **Smart Dimension**  (S) on the Sketch toolbar.
- Step 6. Dimension the circles **10.6** and **8**, **Fig. 2**.
- Step 7. Click **Features**  on the Command Manager toolbar.

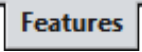
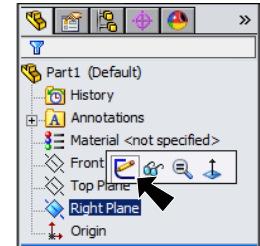

Fig. 1

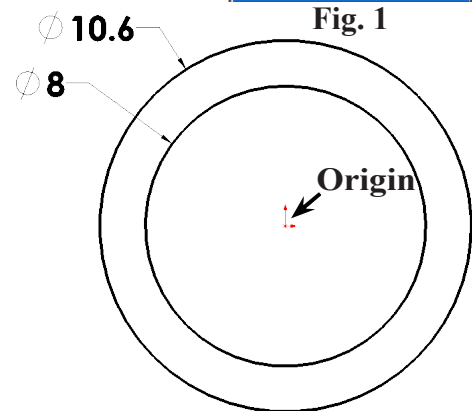
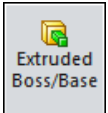



Fig. 2

- Step 8. Click **Extruded Boss/Base**  on the Features toolbar.
- Step 9. In the Property Manager set:  
 under Direction 1, **Fig. 3**  
 End Condition **Mid Plane**  
**Depth**  **.9**  
 click OK  .

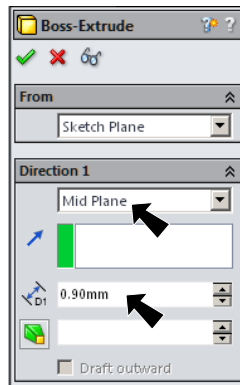

Fig. 3

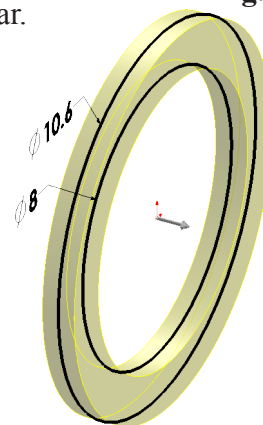



Fig. 4

## B. Save as "WASHER".

- Step 1. Click File Menu > Save As.
- Step 2. Key-in **WASHER** for the filename and press ENTER.

## C. Material Brass.

- Step 1. **Right click** **Material**  in the Feature Manager and click **Edit Material**, **Fig. 5**.
- Step 2. Expand **Copper Alloys** in the material tree and select **Brass**. Click **Apply** and **Close**.
- Step 3. Save. Use **Ctrl-S**.

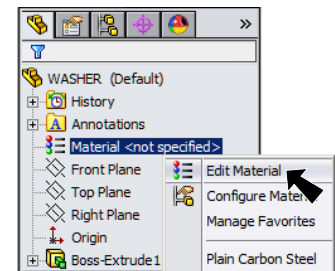

Fig. 5