

Airplane H Stab

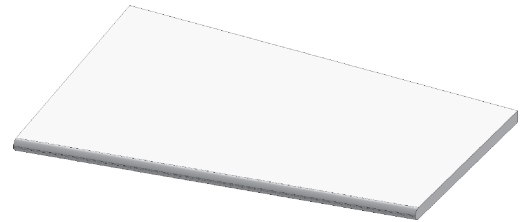

A. Sketch.

Step 1. Click File Menu > New, click **Part** and OK.

Step 2. Click **Top Plane**  in the Feature Manager and click **Sketch** on the context toolbar, **Fig. 1**.

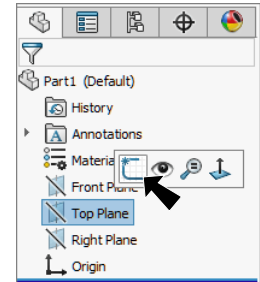

Step 3. Click **Line**  (L) on the Sketch toolbar.

Step 4. Starting at the Origin  sketch lines in **Fig. 2**. Use the inferencing line, the dotted line that appears when you sketch the lines to **keep top line horizontal and right side line vertical**.

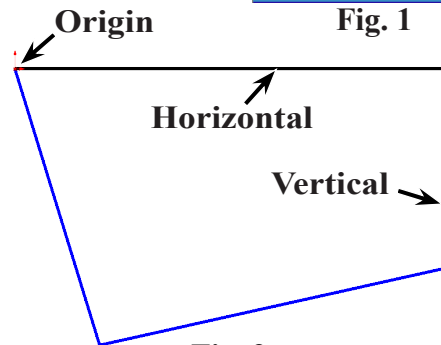

Step 5. Click **Smart Dimension**  (S) on the Sketch toolbar.

Step 6. Add dimensions, **Fig. 3**.

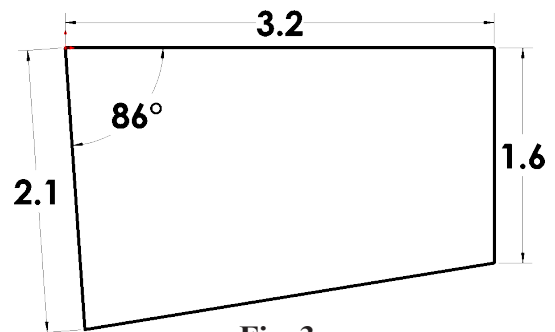

B. Extrude.

Step 1. Click **Features**  on the Command Manager toolbar.

Step 2. Click **Extruded Boss/Base**  on the Features toolbar.

Step 3. In the Boss-Extrude Property Manager set:
under Direction 1, **Fig. 4**
End Condition **Mid Plane**

Depth  **.1**
click OK .

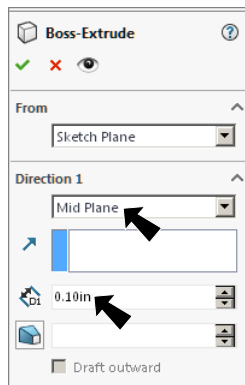

Fig. 4

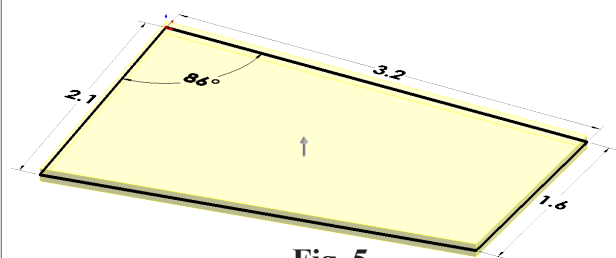

Fig. 5

C. Save as "H STAB".



Step 1. Click File Menu > Save As.

Step 2. Key-in **H STAB** for filename and press ENTER.

D. Fillet Leading Edge.

Step 1. Click **Fillet**  on the Features toolbar.

Step 2. In the Fillet Property Manager set:
select **FilletXpert**, **Fig. 6**

Radius  **.045**
click the **two**
edges of the
leading edge
(front), **Fig. 7**
click OK .

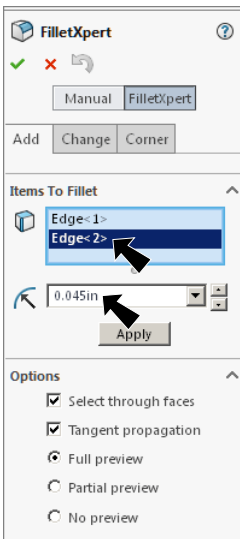

Fig. 6

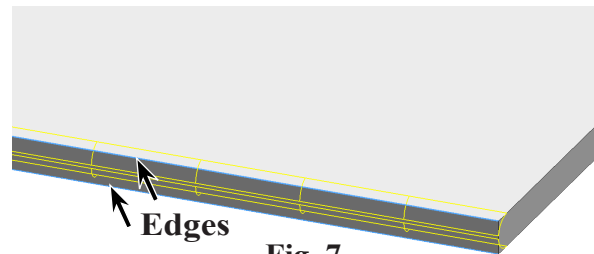



Fig. 7

Step 3. Save. Use **Ctrl-S**.

E. Material PS HI (Polystyrene).

Step 1. **Right click Mate-**
rial  in the Feature
Manager and click **Edit**
Material.

Step 2. **Expand Plastics** in the material tree
and select **PS HI**. Click **Apply** and
Close.

Step 3. Save. Use **Ctrl-S**.



Fig. 8

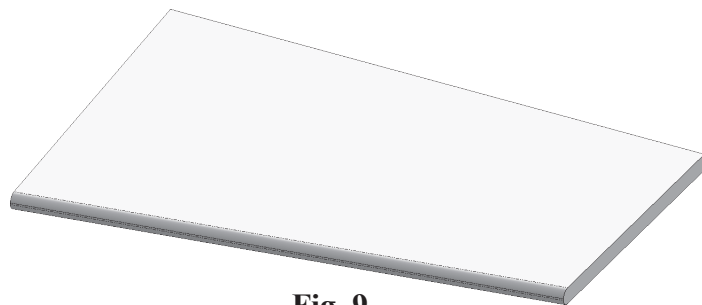

Fig. 9