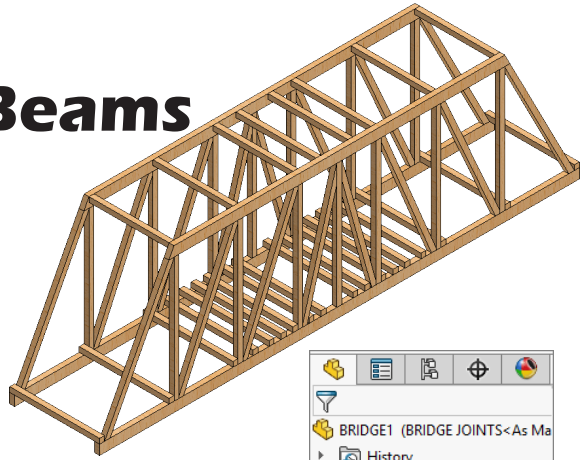





# Add Floor Beams



### A. Edit Simple Span Sketch.

Step 1. If necessary, open your **Bridge1** part file and click **Model** at bottom of graphics area.

Step 2. Expand **SIMPLE SPAN** folder in the Feature Manager, click **Sketch 1** and click **Edit Sketch**  on the context toolbar, **Fig. 1**.

Step 3. Click **Normal To**  on the Standard Views toolbar. (**Ctrl-8**)

Step 4. Click **Line**  (**L**) on the Sketch toolbar.

Step 5. Sketch **4 horizontal lines** across sketch, **Fig. 2**. To terminate chain, double click back on the horizontal line you have just sketched. Start all lines on right vertical line and sketch lines to left side.

Step 6. Click **Smart Dimension**  (**S**) on the Sketch toolbar.

Step 7. Add the dimensions, **Fig. 3**.

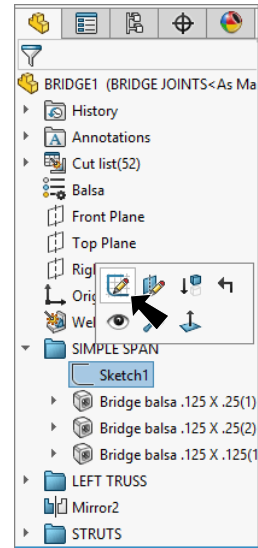


Fig. 1

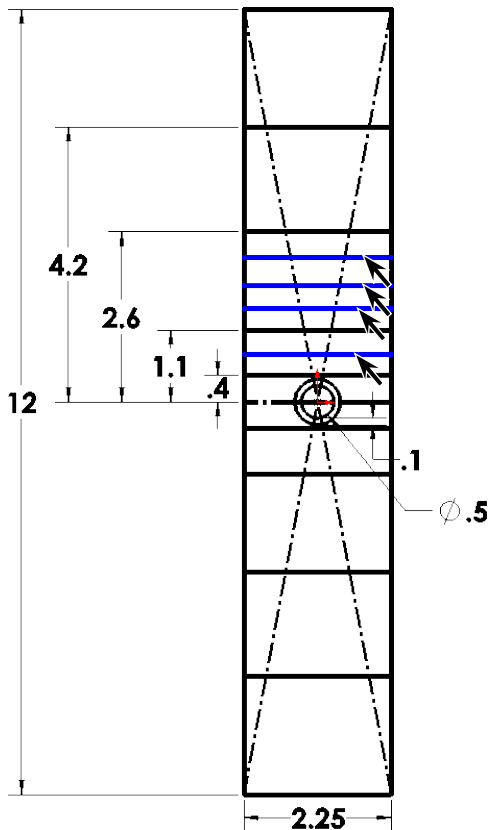


Fig. 2

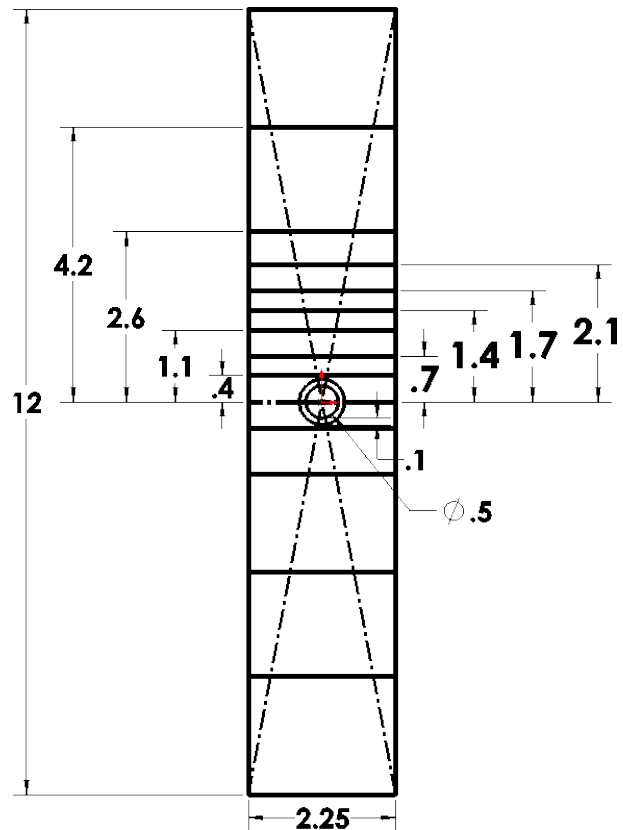



Fig. 3

## B. Mirror Entities.

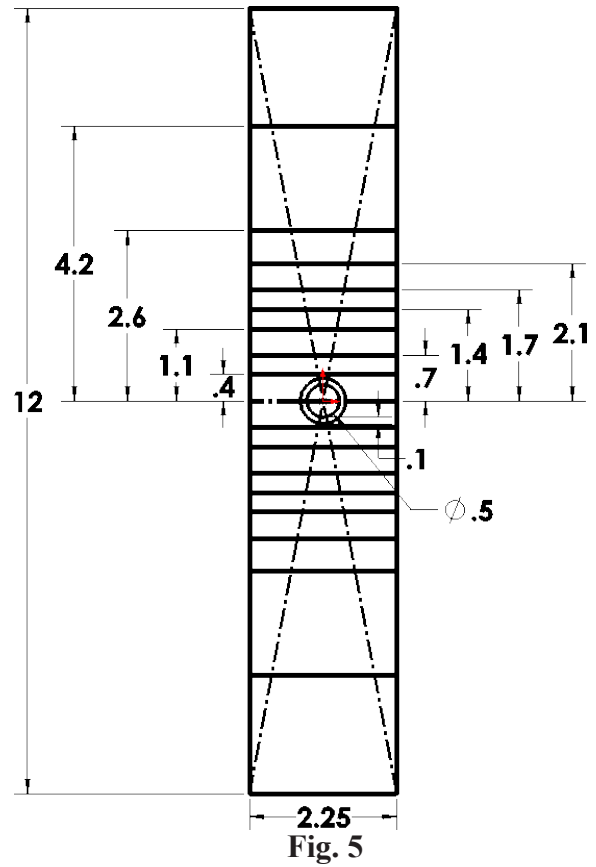
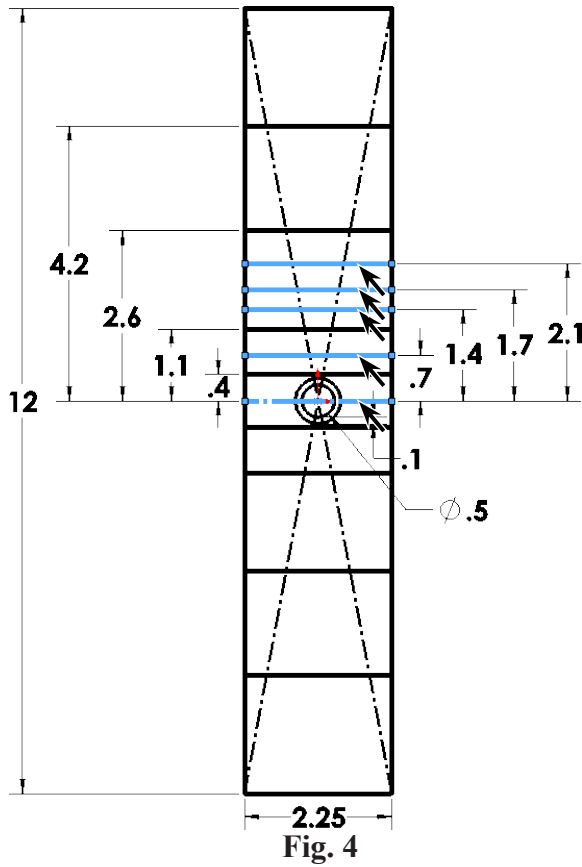
Step 1. Right click graphics area and click Select from menu to unselect Smart Dimension.

Step 2. Ctrl click the 4 new horizontal lines and the centerline to select, Fig. 4.

Step 3. Click Mirror Entities  Mirror Entities on the Sketch toolbar, Fig. 5.


Step 3. Click Exit Sketch  on the Sketch toolbar.

Step 4. Save. Use Ctrl-S.



## C. Edit Structural Member.

Step 1. Click **Isometric**  on the Standard Views toolbar. (Ctrl-7)

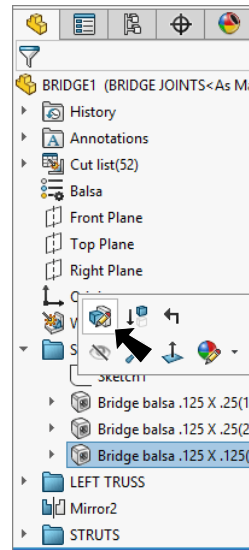
Step 2. Click **Structural Member3** in the Feature Manager and click **Edit Feature**  in the context toolbar, **Fig. 6**.

Step 3. In the Structural Member Property Manager set: under Selections in the Groups box click **Group3**, **Fig. 7**

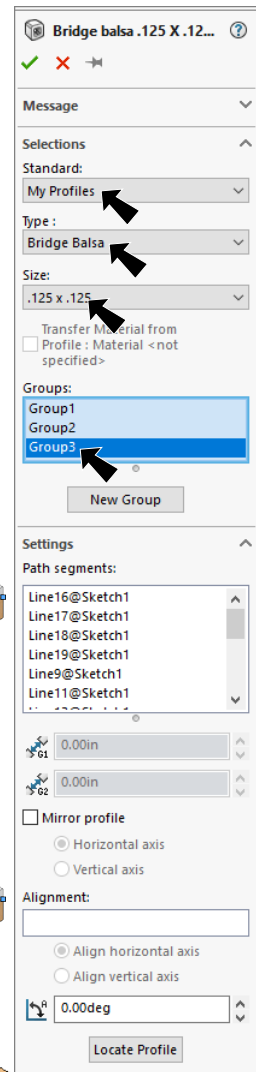
click the **8 new floor beam lines**  
do not select the centerline  
**Fig. 8 and Fig. 9**

click OK .

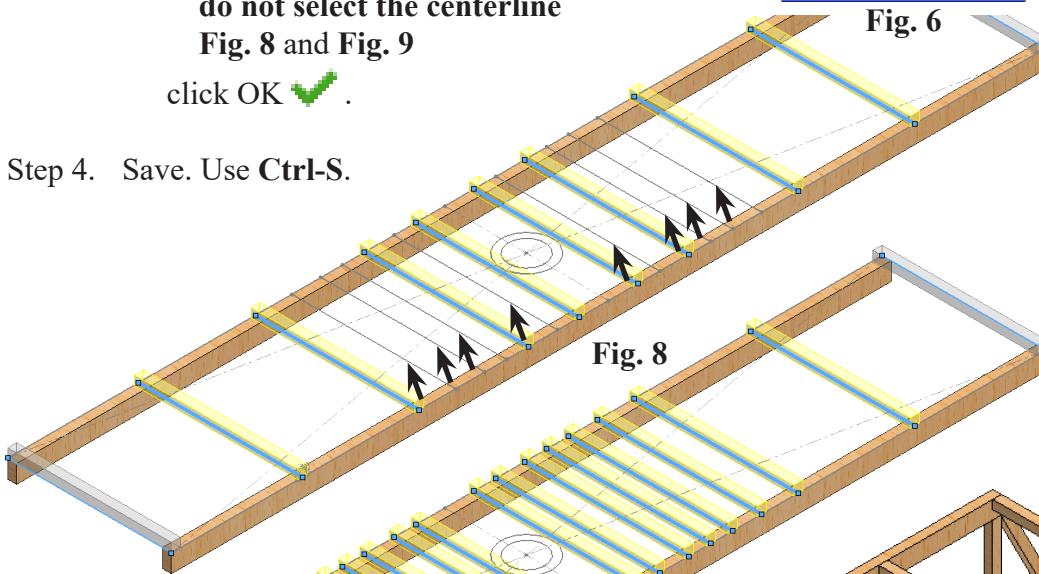
Step 4. Save. Use **Ctrl-S**.



**Fig. 6**

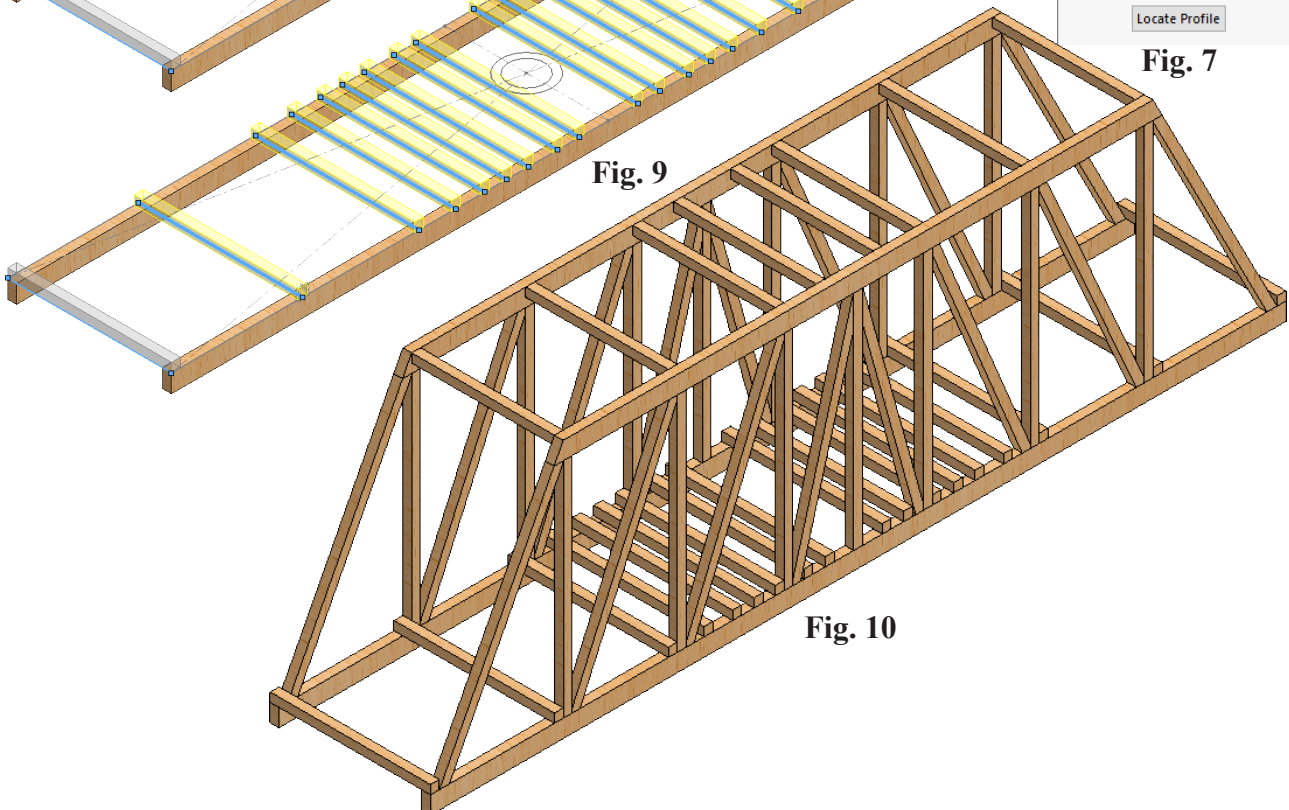


**Fig. 7**



**Fig. 8**

**Fig. 9**



**Fig. 10**