



A. Sketch.

Step 1. Click File Menu > New, click **Part** and OK.

Step 2. Click **Top Plane**  in the Feature Manager and click **Sketch**  on the context toolbar, **Fig. 1**.

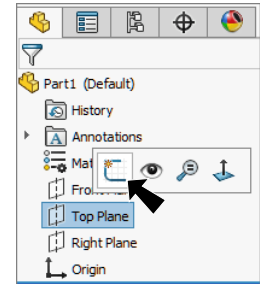

Fig. 1

Step 3. Click **Center Rectangle**  in the **Rectangle** flyout  on the Sketch toolbar.

Step 4. Sketch a rectangle starting at Origin , **Fig. 2**.

Step 5. Click **Smart Dimension**  (S) on the Sketch toolbar.

Step 6. Dimension 2 x 6, **Fig. 2**.

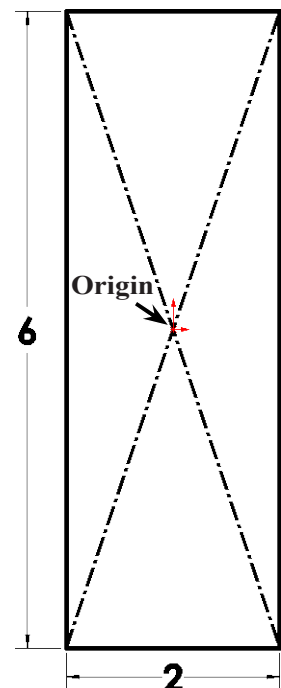

Fig. 2

B. Save as "BLOCK".

Step 1. Click File Menu > Save As.

Step 2. Key-in **BLOCK** for filename and press ENTER.

C. Extrude.

Step 1. Click **Features**  on the Command Manager toolbar.

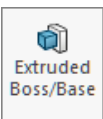
Step 2. Click **Extruded Boss/Base**  on the Features toolbar.

Step 3. In the Boss-Extrude Property Manager set:
under Direction 1, **Fig. 3**

Depth  **D1** .75
click OK .

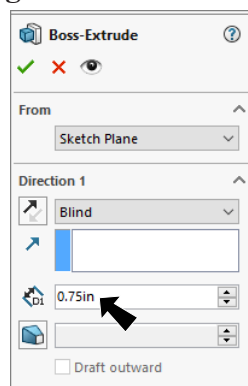

Fig. 3

Step 4. Save. Use **Ctrl-S**.

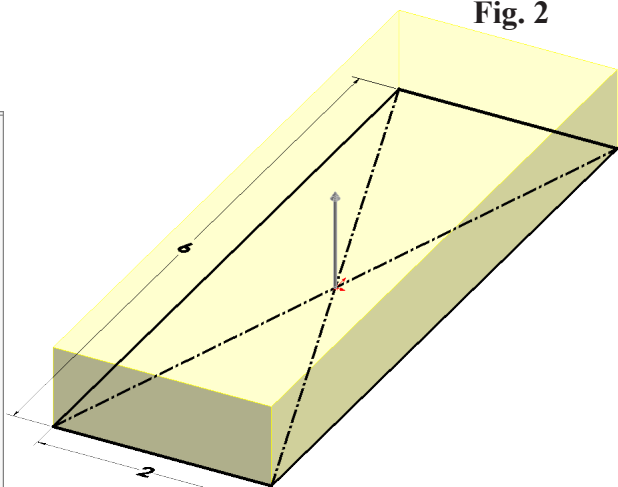



Fig. 4

D. Hole Wizard 33/64" Hole.

Step 1. Click **Hole Wizard**  on the Features toolbar.

Step 2. In the Property Manager, on the Type tab set:
under Hole Type, **Fig. 5**

click **Hole** 
under Standard:
select **ANSI Inch**
under Type:
select **Fractional Drill Sizes**
under Size:
select **33/64**
under End Condition
End Condition **Through All**

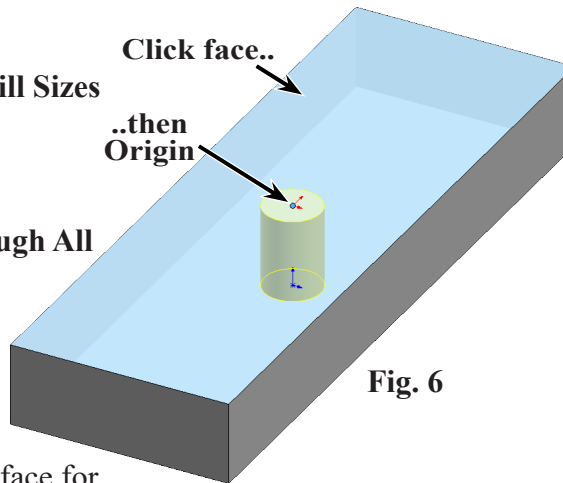

Fig. 6

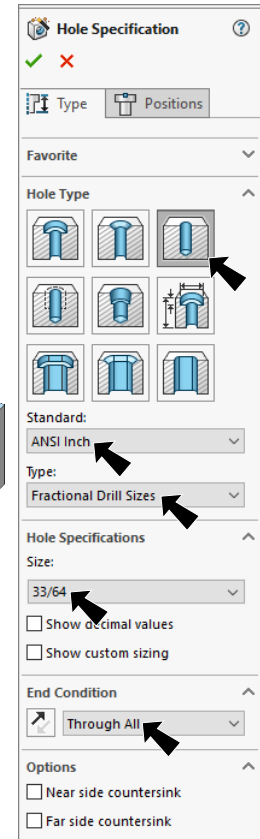



Fig. 5

Step 3. Click **Positions** tab  at top of the Property Manager.

Step 4. Click **top face** one time as face for
hole and then click **Origin**  to place hole, **Fig. 6**.

Step 6. Click OK  in Hole Property Manager.

E. Material Steel.

Step 1. **Right click Material**  in the Feature Manager and click **Edit Material**, **Fig. 7**.

Step 2. Expand **Steel** in the material tree and select **Plain Carbon Steel**. Click **Apply** and **Close**.

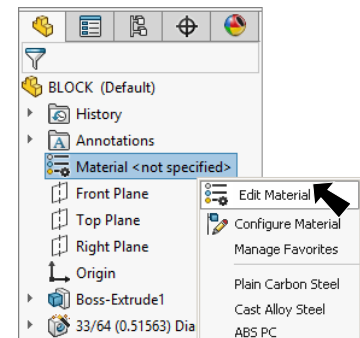

Fig. 7

Step 3. Save. Use **Ctrl-S**.

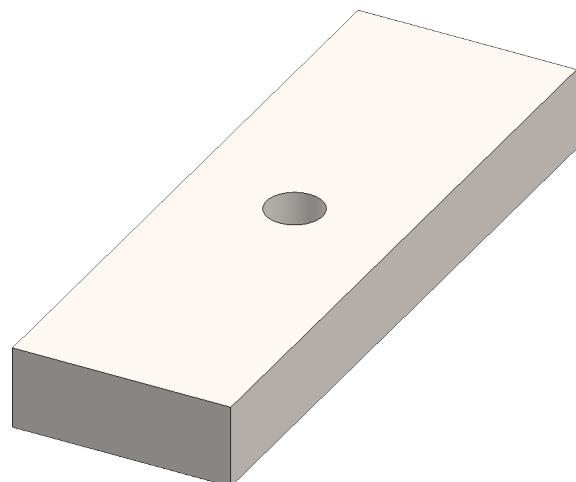

Fig. 8