

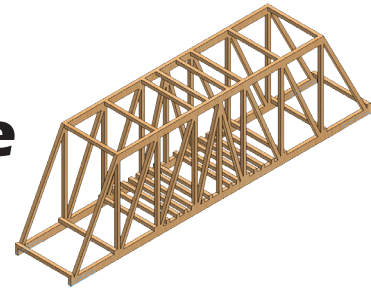

# Bridge Combine



## A. Add Configuration.

Step 1. Open your **Bridge1** part file.

Step 2. If necessary, click **Model** tab  at the bottom left of the graphics area.

Step 3. Click **Configurations Manger** tab  in the Feature Manager to display the Configuration Manager, **Fig. 1**.

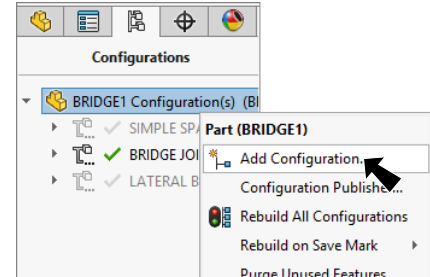

**Fig. 1**

Step 4. **Right click** **Bridge1 Configuration(s)**  and click **Add Configuration**, **Fig. 1**.

Step 5. In the Add Configuration Manager set:  
 under Configuration Name **Fig. 2**  
 key-in **BRIDGE COMBINE**  
 click OK .

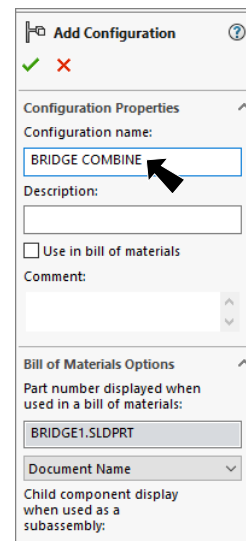

**Fig. 2**

Step 6. Click **Feature Manager Design Tree** tab  at the top of the Configuration Manager to display Feature Manager, **Fig. 3**.

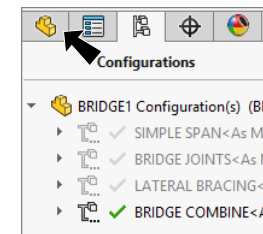
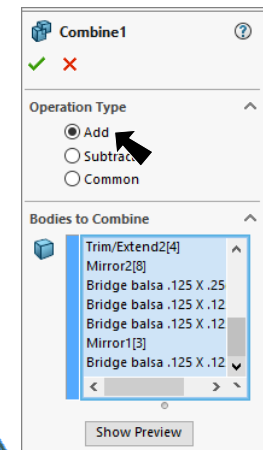

**Fig. 3**

## B. Combine Bodies.

Step 1. Click Insert Menu > Features > Combine.

Step 2. In the Combine Property Manager set:  
 under Operation Type, **Fig. 4**  
 select **Add**  
**drag selection around the Bridge**  
 to select all, **Fig. 5**  
 click OK .



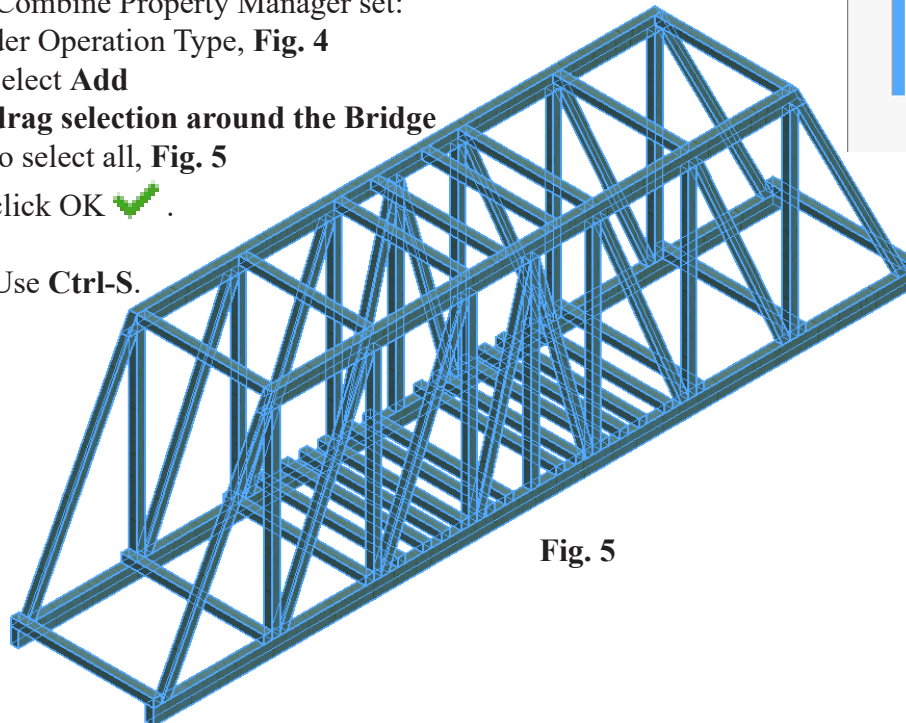

**Fig. 4**

Step 3. Save. Use **Ctrl-S**.





**Fig. 5**

### C. Sketch for Fixtures Split Line.

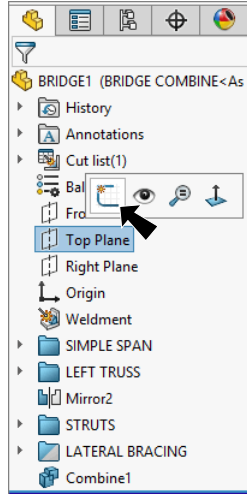
Step 1. Click **Top Plane**  in the Feature Manager and click **Sketch**  on the context toolbar, **Fig. 6**.



Step 2. Click **Normal To**  on the Standard Views toolbar. (**Ctrl-8**)

Step 3. Click **Center Rectangle**  in the **Rectangle** flyout  on the Sketch toolbar.

Step 4. Sketch rectangle starting at Origin

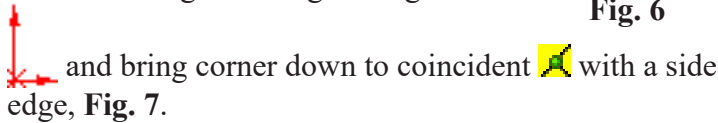

Step 5. Click **Smart Dimension**  (**S**) on the Sketch toolbar.

Step 6. Dimension **1** from top edge, **Fig. 8**.

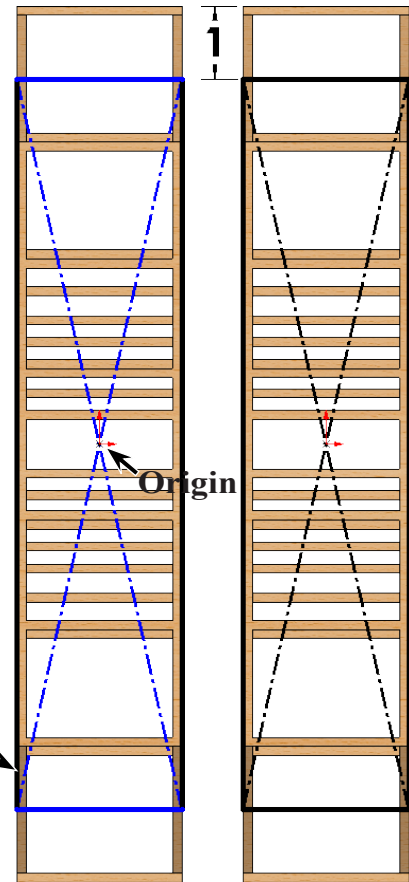

**Fig. 7**

**Fig. 8**

### D. Split Line 1 for Fixtures on Bottom.



Step 1. Click **Bottom**  on the Standard Views toolbar. (**Ctrl-6**)

Step 2. Click Insert Menu > Curve > Split Line.

**Bottom faces**

Step 3. In the Split Line Property Manager: under Type of Split, **Fig. 9** select **Projection**

under Selections  **Sketch** should be selected

in the Faces to Split box  click **bottom faces**, **Fig. 10** click OK .

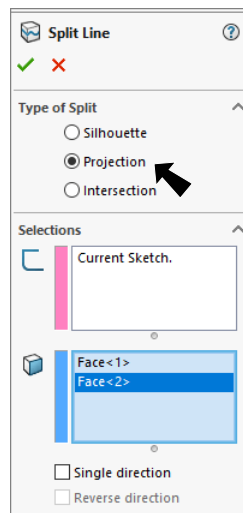

**Fig. 9**

Step 4. You can confirm the split faces by selecting the new faces. Here faces were Ctrl clicked to show all four faces, **Fig. 11**.

Step 5. Save. Use **Ctrl-S**.

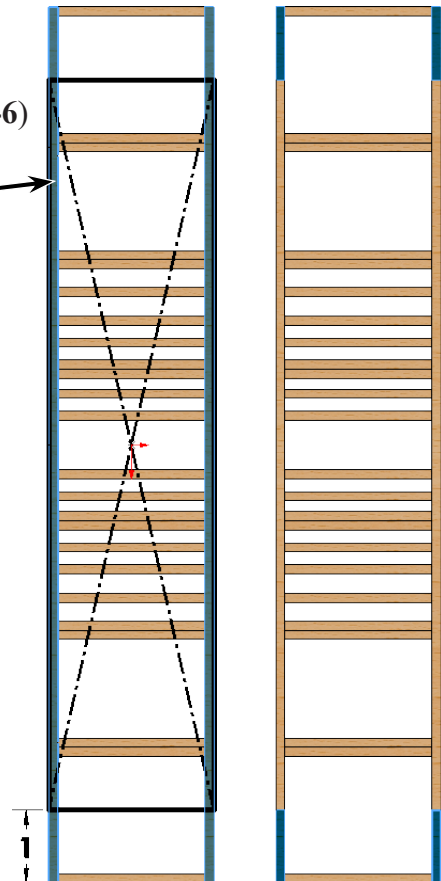

**Fig. 10**

**Fig. 11**