



A. Washer.

Step 1. Click File Menu > New, click **Part Metric** and OK.
 Step 2. Click **Right Plane**  in the Feature Manager and click **Sketch**  on the context toolbar, **Fig. 1**.

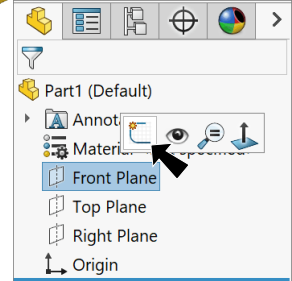

Fig. 1

Step 3. Click **Circle**  (S) on the Sketch toolbar.

Step 4. Sketch two circles starting at the Origin , **Fig. 2**.

Step 5. Click **Smart Dimension**  (S) on the Sketch toolbar.

Step 6. Dimension circle **diameters 3.7 and 7.8**, **Fig. 2**.

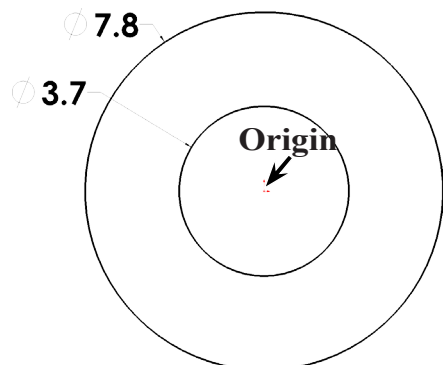

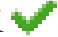

Fig. 2

Step 7. Click **Features**  on the Command Manager toolbar.

Step 8. Click **Extruded Boss/Base**  on the Features toolbar.

Step 9. In the Property Manager set:
 under Direction 1, **Fig. 3**
 End Condition **Mid Plane**
 Depth  **.8**
 click OK .

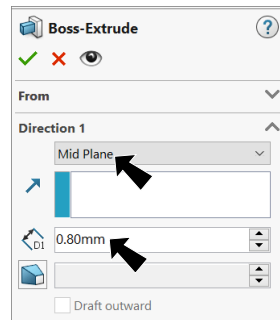

Fig. 3

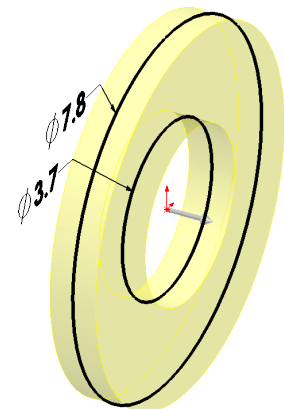

Fig. 4

B. Save as "WASHER".

Step 1. Click File Menu > Save As.

Step 2. Key-in **WASHER** for the filename and press ENTER.

C. Mate Reference.

Step 1. Click a cylindrical face to select it, Fig. 5.

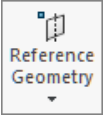
Step 2. Click **Reference Geometry**  on the Features toolbar and **Plane** from the menu.

Step 3. In the Mate Reference Property Manager click OK  , Fig. 6.

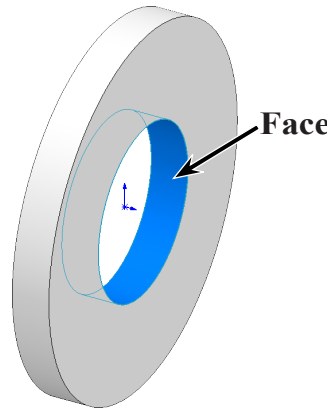

Fig. 5

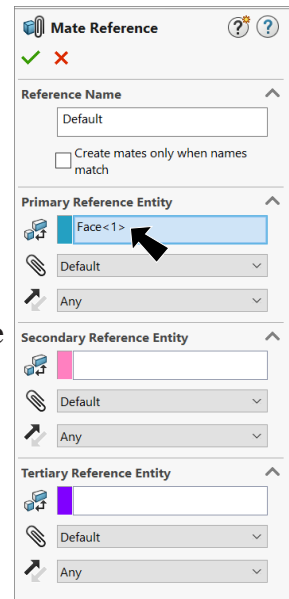

Fig. 6

D. Material Brass.

Step 1. **Right click Material**  in the Feature Manager and click **Edit Material**.

Step 2. Expand **Copper Alloys** in the material tree and select **Brass**. Click **Apply** and **Close**.

Step 3. Save  (Ctrl-S).

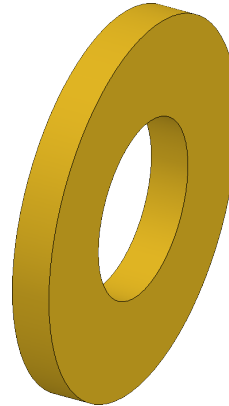

Fig. 7